

Several Tamiya Sonic Fighters, please note that the photograph top right shows other Tamiya equipment which is not included in the kit.

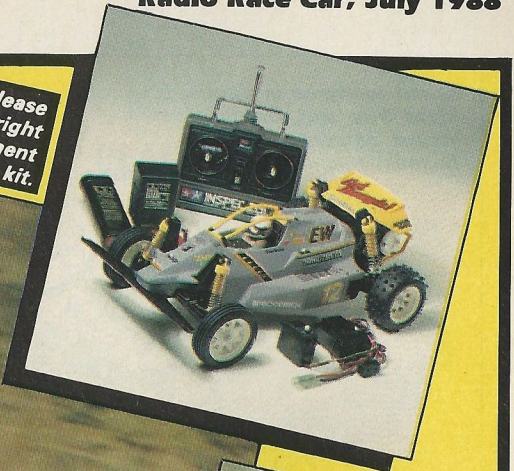

This futuristic 2WD racer from Tamiya is looked at by Warren Dawson

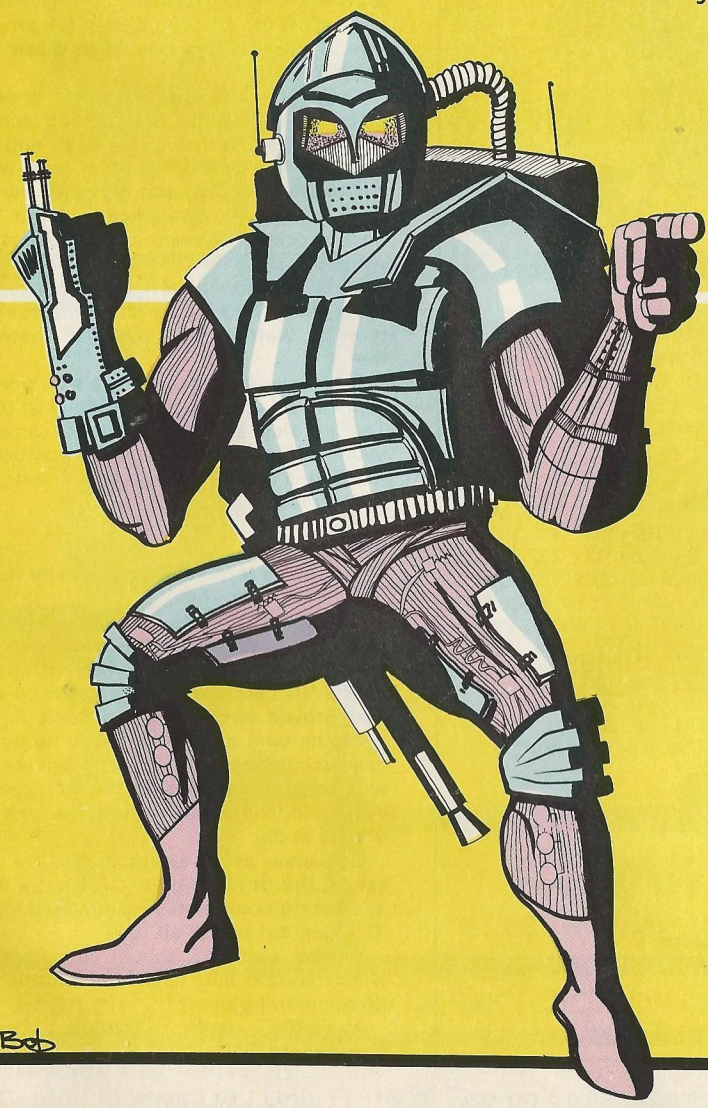

SONIC FIGHTER

Tamiya's policy has always been one of development, steadily improving both their new and existing range of radio controlled cars, allowing a gradual up grade by their owners to the very latest spec. One point worthy of note is that Tamiya have seemed to spread this development across the complete range of radio cars, the Sonic Fighter is no exception, its parentage is obvious yet here again we are presented with another fine example of Tamiya's product.

Open The Box
Yet again the presentation and packaging of the Sonic Fighter is first rate, this defi-

Bob

Speed controller is a un-
itized item and once in-
stalled correctly should
be maintenance free.

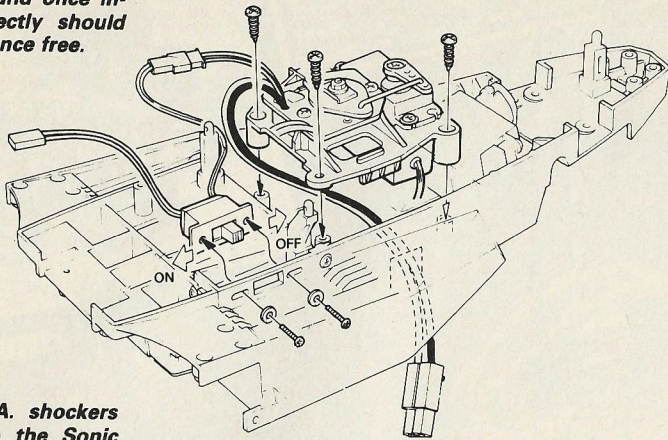

Tamiya C.V.A. shockers
are fitted to the Sonic
Fighter and are up to the
usual high standard.

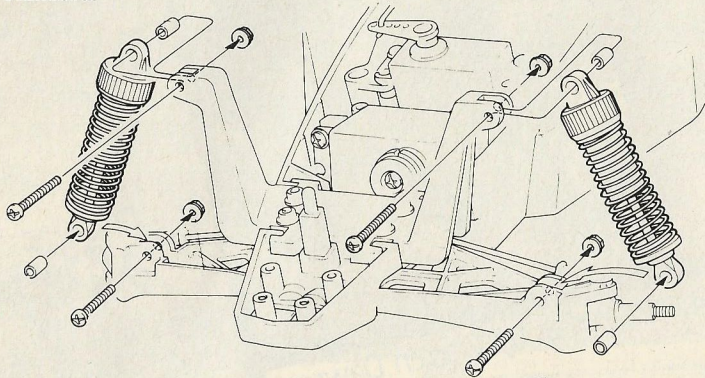

A simple to build and
maintain gearbox trans-
mits the drive from the
motor.

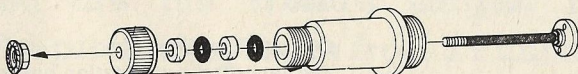
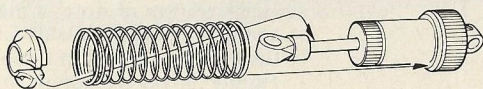
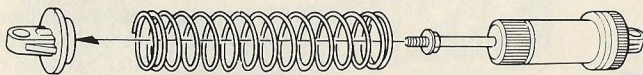
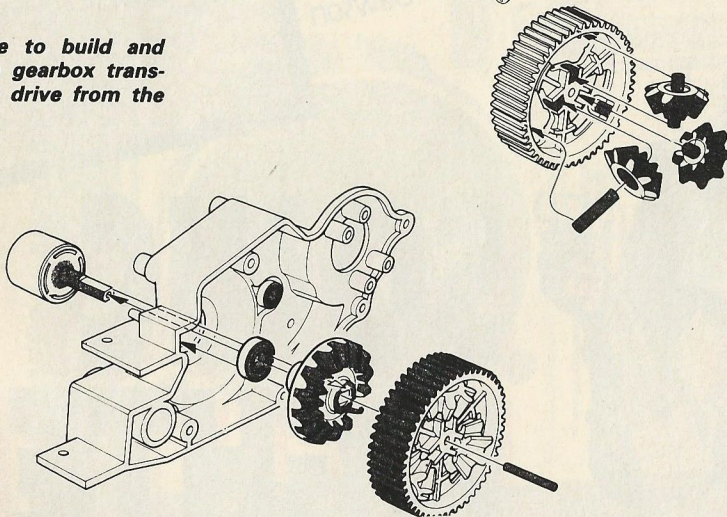

nately helps the first time builder come to grips with his car. Instructions are as ever, first class.

Ready, Set, Go

The first stage of building the Sonic Fighter is assembly of the six point speed controller, three forward and three reverse speeds are used. Always make sure the servo is in the neutral position before connecting it to the speedo, it's then fixed into the cars bath-tub chassis.

The servo saver is placed on the steering servo, the track rods are hooked in place, make sure the rods are the length stated in the book (75 mm for the right and 59 m for the left), making sure you have a fraction of toe-in on the front wheels.

Next the very popular C.V.A. shocks which are also in kit form. The sonic fighter has four independent shocks unlike the striker. The shocks run very smooth and are simple to construct. Three different pistons are included to set the damping rate for the type of surface you wish to run your car on.

When building the gearbox be sure all the parts are greased as shown in the instruction book. The gearbox is held together by four screws. The back end is protected by a strong motor guard.

The (16 tooth) motor pinion is put into place and the motor placed into the gearbox, with a small amount of grease on the pinion, be sure to use the correct holes when screwing the motor in place.

The rear end is put into place on the back of the bath-tub chassis and held in place by four self-tapping screws. The receiver is placed on top of the chassis for an easy crystal change, this is held in place by a urethane band.

The rear shock and wing stay is put in place by four more self-tapping screws. The rear trailing arm, drive shaft and side plate have to be entered all at once which can prove annoying and tricky for the first time builder, but patience will out. The back shocks are constructed and put into place.

The tyres are put on to the hubs which is fairly easy. If you have problems soak the tyres in warm water to soften them up, then try.

The body is put together, a side panel is screwed on and a roll cage is put in place. Tamiya also supply a colourful array of stickers to put on the white plastic body. I found this car very easy to build and great fun to race.

Conclusion

This car was raced at Kidderminster indoor track and Chesterfield:-

The indoor track at Kidderminster was carpet and very tight and twisty and I did not expect to do well, when competing with 4WD cars. But I am pleased to say I was proved wrong and the Sonic Fighter holds its own and proved very nippy and easy to handle. In fact in a very private race with team mate Kevin Griffin who raced a 4WD mid, the Sonic Fighter was not disgraced at all.

Outdoors at Chesterfield in the RRC series, the Sonic Fighter attracted a lot of interesting comments and qualified for the 'C' Final, not bad at all.

Overall a strong, robust club level car which should suit new and intermediate drivers admirably.

Available from Tamiya Dealers everywhere.